

# VIC. PRODUCTS



R8-1A(V) 300x450  
R8-1B(V) 450x600



R8-2A(V) 300x450  
R8-2B(V) 450x600



R8-3A(V) 300x450  
R8-3B(V) 450x600

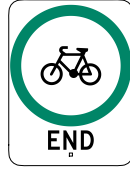

R8-4A(V) 300x450  
R8-4B(V) 450x600



R8-5A(V) 300x450  
R8-5B(V) 450x600



R8-6A(V) 300x450  
R8-6B(V) 450x600



**TOTAL FIRE BAN TODAY**  
FIRE CLOCK & SUPPORT SIGN



FIRE WARNING SIGN



300X450  
450X600



300X450



450X600



W5-V35B  
750x750



W8-22B  
750x500



FOLDING STOP  
R1-V6HG  
750



TR1-V5-2km  
TR1-V5-5km  
750x900  
BOX SECTION



FOLDING  
R1-V6HG  
BOX SECTION  
TR1-V6  
900x900

# N.T. PRODUCTS

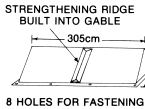

## WHITE GABLE BOUNDARY MARKERS

Used to define the limits of the aircraft movement area.

8 HOLES FOR FASTENING

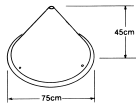

## CONE MARKERS

USED AS:  
WHITE: Boundary and temporary displaced threshold markers.  
Wind indicator contrast circles.  
YELLOW: To define taxiways, aprons, designated aircraft, aircraft parking areas.  
GREEN & DUN COLOURED: For marking available strip area behind displaced thresholds

4 HOLES FOR FASTENING

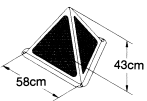

## REFLECTOR CONES

These cones have Reflective panels and are for giving pilots a better alignment of runways or taxiways at night time. Available in standard cones or new Triangular shape.

Yellow with Blue band for Taxiways  
White with Silver for Runways  
Blue with Blue for Helipads

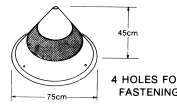

## UNSERVICEABILITY CONES

White with 23cm permanently impregnated red band. Hazards, ditches, drains, unserviceable areas.



## GENERAL PURPOSE CONE MARKER

This cone is suitable for any cone application, but its main purpose is for use on hard surfaces where conventional fastening cannot be used or for use on a temporary basis when cones are needed to be placed out quickly. Very useful in cyclone prone areas, where cones can be taken in quickly. These cones are produced in White for Runway markers, yellow for taxiways or with a 23cm red band for unserviceability marking.

**THESE CONES ARE STACKABLE AND ARE EASILY TRANSPORTED**

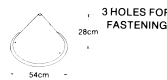

## TRUNCATED CONE

Normally white, used as runway edge markers.



Galvanised steel fasten down spikes available 35cm long.

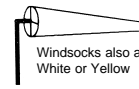

Windssocks also available White or Yellow

# TAS. PRODUCTS



FRONT



BACK

1200x600



600x250

600x250

REAR MARKER PLATES

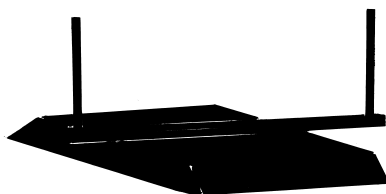

TEMP AD BASE STAND